

**AIXECAMENT TOPOGRÀFIC ÀMBIT DEL
CENTRE D'ATENCIÓ PRIMÀRIA
TERME MUNICIPAL DE SANT JUST
DESVERN**

Sibina topografia S.L.
11 de novembre de 2025

ÍNDEX

ÍNDEX.....	2
MEMÒRIA DESCRIPTIVA.....	3
Objectiu.....	3
Ubicació del projecte.....	3
Autors del document.....	3
CARACTERÍSTIQUES TÈCNIQUES.....	4
Paràmetres tècnics.....	4
Treball de camp.....	4
Treball de gabinet.....	5
Coordenades de les bases.....	5
DOCUMENTACIÓ LLIURADA.....	5
FOTOGRAFIES AIXECAMENT.....	6
COORDENADES DELS PUNTS.....	9

ANNEXES

- Annex I - Certificat de calibratge Estació Total Leica TS16
- Annex II – Certificat de calibratge Làser escàner Leica RTC 360
- Annex III _ Certificat de calibratge Receptor GNSS Leica GS18
- Annex IV – Ressenyes Bases Replanteig i de Referència de XTM
- Annex V- Plànols
 - Plànol de Situació
 - Plànol Guia
 - Planta General
 - Fulls Planta escala 1:200
 - Secció transversal

MEMÒRIA DESCRIPTIVA

- **Objectiu**

L'objectiu dels presents treballs és realitzar un aixecament topogràfic de detall de la zona d'estudi, l'àmbit del Centre d'Atenció Primària comprés entre el Carrer de Jacint Verdaguer i l'Avinguda de la Indústria, al terme municipal de Sant Just Desvern.

La finalitat de l'aixecament és poder definir la planimetria, les cotes, les pendents del terreny, registres, etc. També s'han monumentat i observat bases de replanteig per a futurs treballs.

L'objectiu del present informe és la descripció de l'execució dels treballs de topografia realitzats així com dels resultats obtinguts.

- **Ubicació del projecte**

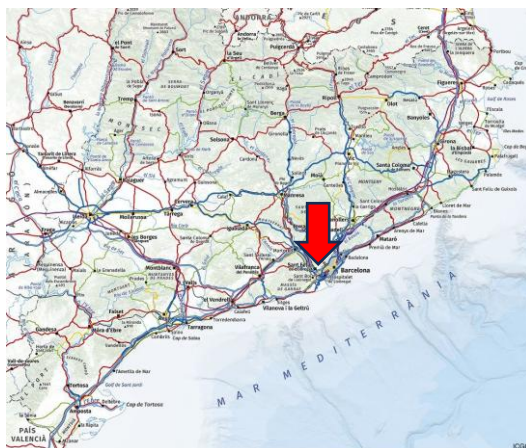

Sant Just Desvern (Baix Llobregat)

- **Autors del document**

Empresa: Sibina Topografia S.L., B67218314
Enginyer tècnic en topografia: Daniel Fera Rodríguez,
Col·legiat núm 8712

Signatura

CARACTERÍSTIQUES TÉCNIQUES

• Paràmetres tècnics

- Mètode d'aixecament: Topografia clàssica i Làser-escàner
- Sistema de coordenades: Sistema ETRS89 projecció UTM Fus31N
- Alçades: cota Ortomètrica referida al nivell mig del mar a Alacant
- Escala del treball: 1:200
- Aparell de mesura: **Estació total robotitzada Leica TS16**

- Precisió angular 3^{cc}
- Precisió distància 1 mm + 1.5 ppm

Receptor GPS Leica GS18

- Precisió absoluta de $\pm 1\text{cm}$ en XY i $\pm 1\text{cm}$ en cota

Làser escàner 3D Leica RTC360

• Treball de camp

- Data: 11 de novembre de 2025
- Equip tècnic: 1 enginyer tècnic en topografia
- Senyalització d'estacions: Clau d'acer

L'aixecament s'ha basat en la presa de punts massiva mitjançant làser-escàner. Les bases s'han observat amb una estació total robotitzada TS16 partint de bases de referència de la Xarxa topogràfica Municipal de Barcelona.

S'han mesurat els punts per tal de definir la planimetria i altimetria del terreny i dels elements que s'hi localitzen tals com:

- alineacions i cotes de les edificacions
- alineacions i cotes de murs
- alineacions i cotes de voreres
- cotes de paviment a l'interior de l'edifici i les seves cobertes
- posició en planta i cota de clavegueram, embornals, registres, arbrat, etc.
- Orografia del terreny

- **Treball de gabinet**

La última fase dels treballs són el processament de dades:

- bolcat i depurat de les dades de camp
- delineat en CAD en 3D
- obtenció del model digital del terreny

- **Coordenades de les bases**

BASE	Coordenada X(m)	Coordenada Y(m)	Cota H(m)
5001	422300.963	4581627.946	87.098
5002	422267.986	4581629.024	87.232
5003	422282.371	4581663.103	87.663

DOCUMENTACIÓ LLIURADA

- **Arxius CAD**

- 251107 CAP-SANT JUST DESVERN-2D.dwg
- 251107 CAP-SANT JUST DESVERN-2D+CARTO.dwg
- 251107 CAP-SANT JUST DESVERN_SITUACIÓ.dwg
- 251107 CAP-SANT JUST DESVERN-3D.dwg
- 251107 CAP-SANT JUST DESVERN-SECCIÓ.dwg

- **Arxius ASCII**

- 251107 CAP-SANT JUST DESVERN-BASES.txt
- 251107 CAP-SANT JUST DESVERN-PUNTS.txt

- **Memòria PDF**

- 251107 CAP-SANT JUST DESVERN-INFORME.pdf

FOTOGRAFIES AIXECAMENT

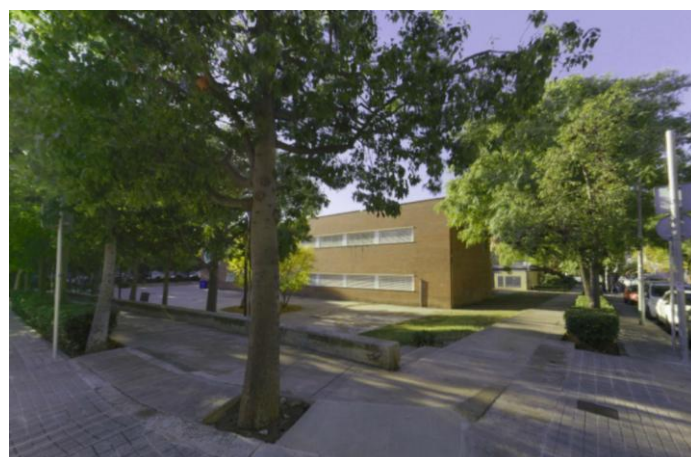

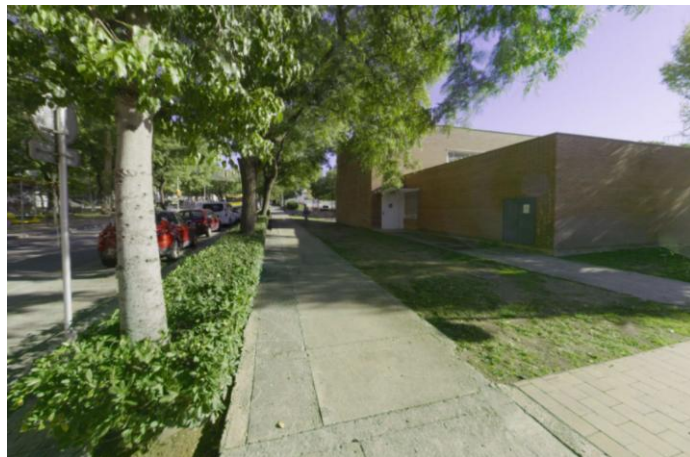

COORDENADES DELS PUNTS

1,422270.334,4581609.345,87.129	79,422276.531,4581630.280,87.507	169,422289.998,4581629.521,87.161
2,422270.679,4581609.667,87.131	80,422278.661,4581631.330,87.511	170,422288.161,4581627.758,87.119
4,422268.105,4581612.442,87.336	81,422279.307,4581631.916,87.449	171,422291.634,4581624.042,86.995
5,422266.401,4581614.276,87.345	82,422280.182,4581629.721,87.452	172,422293.470,4581625.805,87.030
7,422269.686,4581617.296,87.253	83,422280.820,4581630.316,87.403	173,422294.378,4581624.746,87.044
8,422265.228,4581622.134,87.278	84,422279.944,4581630.787,87.365	174,422271.125,4581611.821,87.160
9,422259.770,4581628.049,87.259	85,422282.439,4581628.739,87.359	175,422270.577,4581612.382,87.168
10,422253.160,4581635.214,87.243	86,422282.631,4581627.541,87.373	176,422270.134,4581611.976,87.167
11,422256.255,4581638.127,87.225	87,422281.955,4581627.597,87.397	177,422269.705,4581611.577,87.165
12,422259.715,4581637.964,87.238	88,422282.682,4581626.819,87.342	181,422268.043,4581615.748,89.803
13,422259.795,4581641.488,87.327	89,422283.402,4581627.496,87.307	182,422271.504,4581611.977,89.796
14,422261.147,4581641.972,87.346	90,422285.118,4581624.447,87.241	5001,422300.963,4581627.946,87.098
15,422262.098,4581642.940,87.382	91,422285.669,4581623.835,87.240	5002,422267.986,4581629.024,87.232
16,422261.481,4581643.620,87.398	92,422286.286,4581624.401,87.199	5003,422282.371,4581663.103,87.663
17,422262.787,4581643.545,87.401	93,422285.823,4581624.313,87.137	5004,422219.050,4581631.333,86.683
18,422265.515,4581640.640,87.405	94,422284.135,4581622.109,87.272	5005,422221.363,4581630.855,86.711
19,422272.220,4581614.519,87.185	95,422281.668,4581621.795,87.250	5006,422222.838,4581632.232,86.770
20,422271.731,4581613.973,87.190	96,422276.141,4581614.749,87.183	5007,422223.711,4581633.051,86.816
21,422269.044,4581611.490,87.175	97,422278.825,4581625.123,87.317	5008,422231.807,4581640.642,87.110
22,422268.966,4581611.514,87.327	98,422279.551,4581626.619,87.445	5009,422237.443,4581645.923,87.404
23,422267.041,4581613.284,87.341	99,422280.215,4581626.062,87.417	5010,422248.014,4581655.797,87.802
24,422272.384,4581606.113,87.050	100,422279.851,4581626.735,87.417	5011,422250.360,4581657.988,87.909
25,422274.953,4581603.154,87.009	101,422279.584,4581626.469,87.460	5012,422252.749,4581659.711,88.098
26,422277.566,4581607.253,87.042	102,422276.395,4581629.833,87.425	5013,422253.403,4581660.027,88.134
27,422278.218,4581611.035,87.109	103,422272.901,4581633.572,87.424	5014,422253.994,4581660.198,88.163
28,422278.874,4581611.670,87.121	104,422269.568,4581637.118,87.422	5015,422254.630,4581660.293,88.189
29,422278.854,4581612.013,87.128	105,422266.230,4581640.693,87.432	5016,422255.444,4581660.267,88.206
30,422281.877,4581614.467,87.121	106,422263.178,4581643.932,87.418	5017,422256.241,4581660.080,88.215
31,422282.535,4581611.514,87.145	107,422264.817,4581639.754,87.371	5018,422256.969,4581659.859,88.232
32,422282.825,4581615.474,87.134	108,422264.853,4581640.024,87.378	5019,422257.465,4581659.627,88.230
33,422283.649,4581616.821,87.147	109,422265.471,4581639.378,87.376	5020,422258.101,4581659.202,88.228
34,422284.299,4581617.222,87.155	110,422267.083,4581638.225,87.388	5021,422258.597,4581658.767,88.227
35,422284.682,4581617.783,87.161	111,422268.188,4581636.448,87.372	5022,422259.001,4581658.355,88.201
36,422286.888,4581619.148,87.169	112,422268.811,4581635.796,87.373	5023,422261.866,4581655.319,88.008
37,422287.412,4581618.571,87.160	113,422269.470,4581636.421,87.401	5024,422260.547,4581654.076,87.980
38,422286.900,4581618.794,87.159	114,422270.147,4581635.482,87.392	5025,422302.528,4581625.979,86.903
39,422289.234,4581620.040,87.134	115,422269.611,4581635.002,87.372	5026,422301.478,4581626.056,86.877
40,422288.576,4581620.733,87.151	116,422270.827,4581633.688,87.366	5027,422300.443,4581626.310,86.856
41,422289.212,4581621.307,87.101	117,422271.559,4581632.892,87.361	5028,422299.558,4581626.683,86.849
42,422290.000,4581620.429,87.057	118,422272.154,4581632.231,87.361	5029,422298.300,4581627.381,86.840
43,422290.983,4581621.283,87.038	119,422272.825,4581632.854,87.403	5030,422297.295,4581628.127,86.858
44,422291.089,4581621.376,86.923	120,422273.456,4581631.901,87.388	5031,422296.673,4581628.728,86.876
45,422290.002,4581622.656,86.955	121,422272.937,4581631.404,87.363	5032,422296.047,4581629.421,86.905
46,422289.793,4581622.676,87.072	122,422274.179,4581630.099,87.364	5033,422294.206,4581631.400,87.016
47,422290.422,4581623.523,87.060	123,422274.869,4581629.329,87.371	5034,422289.160,4581636.770,87.288
48,422291.034,4581623.772,87.025	124,422275.517,4581628.667,87.370	5036,422274.836,4581652.103,87.829
49,422291.310,4581623.849,86.982	125,422276.165,4581629.339,87.411	5037,422271.074,4581656.098,87.988
50,422287.980,4581627.399,87.108	126,422276.646,4581628.045,87.399	5038,422268.878,4581658.459,88.097
51,422287.980,4581627.048,87.192	129,422277.616,4581625.435,87.378	5039,422267.110,4581660.343,88.179
52,422284.945,4581630.276,87.322	136,422268.552,4581622.871,87.247	5040,422266.297,4581661.247,88.335
53,422285.016,4581630.528,87.230	137,422266.055,4581622.105,87.266	5041,422265.623,4581661.970,88.367
54,422283.745,4581629.357,87.226	138,422265.714,4581621.807,87.263	5042,422262.994,4581664.809,88.462
55,422283.705,4581629.153,87.304	139,422265.296,4581622.251,87.267	5043,422262.609,4581665.279,88.477
56,422283.495,4581629.712,87.218	142,422271.401,4581625.086,87.194	5044,422262.346,4581665.629,88.490
57,422278.287,4581635.152,87.323	144,422271.219,4581625.799,87.189	5045,422262.220,4581665.896,88.505
58,422278.173,4581635.060,87.442	145,422274.039,4581627.976,87.331	5046,422262.041,4581666.361,88.519
59,422272.675,4581640.894,87.610	146,422270.739,4581631.558,87.312	5047,422261.947,4581667.107,88.544
60,422272.775,4581640.999,87.508	147,422265.244,4581626.506,87.257	5048,422261.949,4581667.650,88.533
61,422266.846,4581647.382,87.632	148,422263.061,4581624.483,87.273	5049,422262.005,4581668.114,88.531
62,422266.695,4581647.274,87.804	149,422261.888,4581630.061,87.234	5050,422262.144,4581668.592,88.528
63,422266.150,4581645.951,87.855	150,422264.787,4581632.253,87.179	5051,422262.591,4581669.457,88.492
64,422270.385,4581641.435,87.708	151,422264.334,4581632.739,87.160	5052,422262.824,4581669.821,88.506
65,422270.650,4581641.223,87.698	153,422267.413,4581635.163,87.316	5053,422263.665,4581670.638,88.553
66,422271.236,4581641.213,87.675	154,422264.288,4581638.843,87.338	5054,422265.734,4581672.724,88.671
67,422271.146,4581640.829,87.661	155,422261.366,4581636.226,87.224	5055,422251.584,4581659.011,87.970
68,422274.510,4581637.051,87.581	156,422258.558,4581633.628,87.254	5056,422255.516,4581662.698,88.198
69,422277.106,4581634.254,87.498	157,422256.384,4581631.730,87.272	5057,422261.319,4581668.232,88.446
70,422275.254,4581632.001,87.567	158,422258.165,4581638.503,87.270	5058,422264.811,4581658.170,88.153
71,422276.497,4581633.670,87.557	159,422259.483,4581639.527,87.256	5059,422259.160,4581653.414,88.184
72,422273.780,4581644.527,87.667	160,422265.797,4581645.373,87.781	5060,422258.531,4581652.800,88.197
73,422269.991,4581640.580,87.749	161,422269.319,4581641.626,87.679	5061,422259.233,4581653.495,88.179
74,422265.259,4581645.590,87.848	162,422272.622,4581638.066,87.602	5062,422256.844,4581656.067,88.321
75,422263.179,4581634.527,87.863	163,422276.254,4581634.458,87.453	5063,422255.892,4581656.854,88.345
76,422266.473,4581640.979,87.770	164,422269.407,4581651.100,87.901	5064,422254.951,4581657.272,88.337
77,422270.696,4581636.522,87.669	166,422274.490,4581644.784,87.651	5066,422253.349,4581657.586,88.210
78,422273.182,4581633.857,87.603	167,422281.570,4581638.304,87.491	5067,422251.211,4581655.598,88.042

5068,422250.477,4581654.925,88.010
5069,422248.889,4581653.407,87.947
5070,422248.310,4581654.007,87.912
5071,422248.200,4581654.122,87.900
5072,422239.485,4581645.947,87.550
5073,422232.898,4581639.822,87.278
5074,422225.241,4581632.673,86.966
5075,422222.291,4581629.914,86.850
5076,422220.591,4581628.348,86.819
5077,422240.327,4581646.539,87.580
5078,422233.255,4581639.915,87.298
5079,422225.358,4581632.542,86.968
5080,422224.569,4581627.573,86.912
5081,422227.585,4581630.383,86.999
5084,422234.675,4581628.401,87.091
5085,422235.694,4581632.360,87.155
5086,422241.263,4581634.473,87.322
5087,422239.735,4581636.131,87.318
5088,422239.851,4581636.239,87.313
5089,422241.373,4581634.573,87.328
5090,422235.094,4581637.376,87.290
5091,422246.519,4581642.420,87.318
5092,422242.130,4581643.926,87.602
5094,422251.897,4581653.096,88.030
5095,422256.206,4581651.400,87.418
5096,422254.748,4581650.038,87.410
5102,422255.491,4581652.167,87.627
5104,422253.675,4581651.189,87.694
5105,422253.316,4581651.574,87.767
5106,422254.775,4581652.935,87.764
5107,422254.413,4581653.323,87.836
5108,422252.954,4581651.963,87.835
5109,422252.597,4581652.345,87.909
5110,422254.056,4581653.706,87.912
5111,422252.247,4581652.721,87.987
5112,422253.705,4581654.082,87.987
5113,422255.135,4581652.549,87.694
5114,422254.387,4581650.425,87.555
5115,422255.846,4581651.786,87.550
5116,422254.031,4581650.806,87.628
5117,422230.350,4581627.373,86.998
5118,422225.894,4581631.952,87.018
5119,422231.393,4581637.079,87.262
5120,422235.563,4581640.968,87.381
5121,422235.748,4581640.736,87.377
5122,422238.195,4581643.026,87.477
5123,422238.010,4581643.261,87.471
5124,422239.661,4581644.791,87.561
5125,422239.849,4581644.560,87.565
5126,422242.181,4581646.707,87.632
5127,422242.296,4581647.256,87.626
5128,422245.284,4581650.049,87.766
5129,422245.494,4581649.835,87.768
5130,422248.504,4581652.638,87.937
5131,422248.282,4581652.872,87.938
5132,422248.875,4581653.422,87.942
5133,422287.894,4581627.302,87.110
5134,422262.182,4581644.252,87.412
5135,422266.168,4581639.980,87.406
5136,422268.857,4581637.107,87.405
5137,422272.214,4581633.560,87.405
5138,422275.530,4581630.020,87.409
5139,422256.336,4581641.621,87.231
5140,422251.299,4581646.845,87.362
5141,422251.452,4581657.410,88.070
5143,422250.423,4581656.445,88.012
5144,422249.694,4581655.767,87.982
5146,422248.507,4581654.663,87.921
5147,422247.825,4581655.397,87.864
5148,422265.703,4581671.250,88.826
5149,422264.234,4581669.785,88.704
5150,422265.484,4581668.519,88.768
5151,422266.953,4581669.987,88.843
5152,422305.271,4581628.353,87.285
5153,422301.290,4581632.502,87.290
5154,422293.836,4581640.410,87.479
5155,422284.974,4581649.800,87.842
5156,422278.911,4581656.249,88.107
5157,422275.887,4581659.488,88.179
5158,422274.295,4581658.711,88.242

5159,422274.132,4581658.877,88.256
5160,422275.927,4581659.835,88.125
5161,422294.432,4581631.389,87.003
5162,422293.335,4581632.590,87.218
5163,422289.224,4581636.966,87.410
5164,422286.780,4581639.555,87.509
5165,422282.934,4581643.672,87.660
5166,422279.124,4581647.776,87.802
5167,422275.195,4581651.977,87.963
5168,422271.484,4581655.909,88.107
5169,422271.782,4581656.185,88.109
5170,422271.504,4581656.480,88.150
5171,422269.260,4581658.813,88.238
5172,422268.967,4581659.095,88.270
5173,422268.726,4581658.867,88.245
5174,422267.722,4581659.945,88.286
5175,422266.073,4581661.698,88.353
5176,422263.094,4581664.889,88.474
5177,422262.691,4581665.361,88.491
5178,422262.466,4581665.687,88.502
5179,422262.336,4581665.949,88.506
5180,422262.180,4581666.371,88.518
5181,422262.084,4581667.110,88.542
5182,422262.080,4581667.658,88.564
5183,422262.152,4581668.151,88.579
5184,422262.320,4581668.634,88.593
5185,422262.699,4581669.416,88.623
5186,422262.898,4581669.705,88.636
5187,422263.806,4581670.558,88.690
5188,422265.859,4581672.600,88.817
5189,422260.342,4581654.080,88.072
5190,422261.637,4581655.304,88.124
5191,422258.887,4581658.261,88.202
5192,422258.483,4581658.695,88.224
5193,422258.010,4581659.110,88.227
5194,422257.384,4581659.510,88.230
5195,422256.921,4581659.766,88.233
5196,422256.217,4581659.987,88.221
5197,422255.423,4581660.136,88.210
5198,422254.639,4581660.180,88.189
5199,422253.932,4581660.868,88.163
5200,422253.429,4581659.922,88.144
5201,422252.790,4581659.611,88.111
5202,422251.664,4581658.903,88.039
5203,422250.767,4581658.181,87.991
5205,422237.481,4581645.758,87.453
5206,422231.834,4581640.470,87.202
5207,422223.690,4581632.885,86.840
5208,422222.927,4581632.161,86.805
5209,422221.394,4581630.706,86.773
5210,422219.075,4581631.166,86.801
5211,422275.949,4581659.830,87.892
5212,422279.058,4581656.502,87.831
5213,422285.033,4581650.160,87.529
5214,422294.023,4581640.618,87.308
5215,422299.024,4581635.241,87.303
5216,422301.522,4581632.578,87.297
5217,422305.354,4581628.518,87.283
5218,422302.485,4581626.119,87.057
5219,422301.486,4581626.201,87.029
5220,422300.466,4581626.456,87.009
5221,422299.613,4581626.830,86.995
5222,422298.370,4581627.494,86.975
5223,422297.397,4581628.283,86.981
5224,422297.148,4581628.506,86.990
5225,422296.796,4581628.843,86.964
5226,422296.053,4581629.609,86.913
5227,422295.328,4581634.564,87.314
5228,422296.834,4581632.942,87.244
5229,422297.534,4581632.204,87.217
5230,422294.629,4581632.099,87.080
5231,422296.723,4581629.800,86.974
5232,422299.201,4581630.446,87.146
5233,422271.369,4581661.823,88.419
5234,422268.817,4581664.448,88.583
5235,422267.695,4581665.584,88.627
5236,422270.008,4581667.775,88.813
5237,422275.654,4581646.266,87.699
5238,422298.980,4581634.947,87.306
5239,422299.665,4581634.219,87.301

5240,422271.663,4581656.311,88.149
5241,422272.549,4581657.138,88.204
5242,422273.660,4581655.972,88.185
5243,422272.476,4581654.858,88.090
5244,422276.381,4581653.065,88.049
5245,422277.468,4581651.899,88.021
5246,422276.311,4581650.791,87.936
5247,422280.310,4581648.853,87.891
5248,422281.419,4581647.678,87.874
5249,422280.236,4581646.577,87.769
5250,422284.137,4581644.779,87.749
5251,422285.191,4581643.625,87.720
5252,422284.008,4581642.522,87.625
5253,422287.982,4581640.660,87.583
5254,422289.059,4581639.496,87.532
5255,422287.879,4581638.391,87.466
5256,422290.578,4581635.525,87.378
5257,422291.753,4581636.638,87.438
5258,422292.839,4581635.502,87.407
5259,422291.637,4581634.397,87.330
5260,422274.684,4581621.862,87.323
5261,422278.860,4581617.243,87.206
5262,422273.883,4581612.638,87.173
5263,422268.972,4581611.507,87.171
5264,422281.436,4581619.605,87.251
5265,422281.878,4581620.017,87.252
5266,422288.861,4581621.897,87.120
5267,422289.460,4581622.454,87.092
5268,422288.234,4581623.768,87.144
5269,422288.495,4581624.057,87.138
5270,422287.961,4581624.642,87.159
5271,422287.657,4581624.363,87.170
5272,422286.324,4581625.795,87.215
5273,422285.744,4581625.255,87.237
5274,422290.363,4581624.493,87.013
5275,422290.175,4581623.894,87.044
5276,422287.808,4581626.334,87.145
5277,422288.510,4581626.480,87.084
5278,422287.814,4581627.225,87.201
5279,422275.760,4581608.803,87.073
5280,422269.541,4581603.135,87.024
5281,422266.959,4581600.505,86.985
5282,422266.338,4581599.976,86.984
5283,422266.391,4581599.977,86.981
5284,422260.658,4581594.596,87.018
5285,422262.980,4581592.128,87.015
5286,422257.641,4581591.758,87.003
5287,422254.712,4581594.917,87.008
5288,422253.977,4581594.238,87.011
5290,422260.600,4581600.323,87.029
5292,422266.720,4581605.995,87.089
5293,422246.001,4581604.330,87.004
5294,422238.989,4581611.930,86.995
5296,422230.008,4581619.999,87.021
5297,422229.062,4581620.987,87.005
5299,422227.298,4581624.609,87.001
5300,422225.384,4581622.857,87.101
5301,422223.041,4581626.150,86.854
5302,422231.858,4581625.740,87.001
5303,422241.786,4581614.990,87.007
5304,422249.620,4581606.513,87.011
5305,422257.157,4581595.184,86.962
5306,422247.648,4581605.484,86.966
5307,422240.255,4581613.500,86.966
5308,422232.538,4581621.836,86.944
5309,422230.673,4581623.854,86.963
5310,422257.304,4581595.319,86.962
5311,422247.795,4581605.620,86.966
5312,422240.402,4581613.636,86.966
5313,422232.685,4581621.971,86.944
5314,422230.820,4581623.990,86.963
5315,422259.475,4581647.094,87.432
5316,422258.804,4581646.478,87.420
5317,422258.190,4581647.162,87.407
5318,422258.846,4581647.769,87.416
5319,422280.779,4581645.587,87.593
5320,422263.513,4581603.723,87.055
5321,422255.167,4581656.976,88.368
5322,422254.834,4581656.204,88.364
5323,422255.048,4581656.146,88.366

5324,422255.626,4581655.826,88.367
5325,422255.946,4581656.552,88.377
5326,422255.576,4581656.758,88.372
5327,422242.948,4581639.110,87.262
5328,422238.501,4581640.548,87.428
5329,422266.438,4581654.241,87.995
5330,422268.396,4581652.158,87.940
5331,422270.363,4581650.064,87.873
5332,422261.559,4581653.220,87.880
5333,422272.215,4581648.094,87.811
5334,422263.483,4581651.131,87.761
5335,422274.084,4581646.104,87.728
5336,422265.443,4581649.034,87.676
5337,422267.464,4581646.903,87.657
5338,422269.373,4581653.220,87.632
5339,422275.954,4581644.114,87.681
5340,422277.505,4581648.725,87.723
5341,422277.823,4581642.125,87.634
5342,422271.192,4581642.921,87.582
5343,422279.693,4581640.135,87.568
5344,422274.933,4581638.942,87.455
5345,422281.734,4581637.963,87.490
5346,422277.014,4581636.780,87.386
5347,422283.693,4581635.877,87.414
5348,422279.045,4581634.608,87.321
5349,422285.512,4581633.942,87.353
5350,422285.615,4581633.832,87.347
5351,422280.755,4581632.658,87.273
5352,422283.993,4581629.741,87.222
5353,422286.892,4581632.472,87.298
5354,422224.902,4581634.193,86.840
5355,422224.806,4581634.252,86.841
5356,422223.281,4581632.775,86.789
5357,422221.359,4581630.965,86.716
5358,422219.033,4581631.432,86.680
5359,422265.582,4581672.836,86.674
5360,422263.535,4581670.778,86.563
5361,422262.175,4581669.318,86.500
5362,422255.522,4581662.978,86.211
5363,422251.041,4581658.790,87.947
5364,422251.158,4581658.655,87.984
5365,422266.953,4581660.191,88.175
5366,422268.931,4581658.053,88.087
5367,422271.512,4581655.300,87.965
5368,422274.734,4581651.885,87.818
5369,422280.637,4581645.574,87.601
5370,422288.133,4581637.465,87.313
5371,422293.950,4581631.235,87.016
5372,422296.831,4581628.220,86.870
5373,422297.919,4581627.283,86.834
5374,422299.435,4581626.425,86.856
5375,422300.368,4581626.082,86.872
5376,422301.417,4581625.815,86.898
5377,422302.554,4581625.747,86.931
5378,422291.259,4581623.740,86.990
5379,422291.485,4581623.920,86.994
5380,422288.067,4581627.498,87.114
5381,422247.711,4581649.166,87.863
5382,422256.666,4581639.908,87.293
5383,422258.002,4581641.154,87.286
5384,422254.638,4581643.715,87.217
5385,422254.859,4581643.012,87.214
5386,422229.917,4581621.767,87.002
5387,422230.836,4581620.771,86.998
5388,422230.890,4581621.105,86.995

5389,422257.772,4581597.697,86.986
5390,422271.217,4581601.042,86.996
5391,422257.090,4581648.860,87.416
5392,422274.927,4581658.048,88.214
5393,422296.354,4581635.297,87.334
5394,422255.671,4581599.316,87.003
5395,422243.917,4581612.081,86.999
5396,422232.756,4581624.193,87.004
5397,422220.482,4581629.392,86.796
5398,422242.416,4581649.910,87.657
5399,422247.409,4581654.519,87.861
5400,422263.098,4581667.410,88.603
5401,422263.612,4581666.889,88.594
5402,422265.078,4581665.236,88.542
5403,422268.137,4581662.225,88.408
5404,422269.036,4581659.028,88.263
5406,422269.941,4581659.919,88.323
5407,422268.828,4581661.042,88.370
5408,422258.277,4581663.640,88.362
5409,422253.338,4581654.475,88.090
5410,422253.613,4581654.731,88.137
5411,422253.356,4581654.456,88.089
5412,422248.810,4581654.945,87.940
5413,422251.160,4581657.131,88.053
5414,422250.224,4581657.050,87.946
5415,422286.665,4581626.122,87.201
5416,422294.037,4581632.185,87.118
5417,422294.609,4581631.649,87.040
5418,422295.863,4581630.291,86.970
5419,422297.187,4581628.856,87.016
5420,422289.712,4581624.099,87.064
5421,422288.458,4581625.481,87.107
5422,422287.529,4581626.475,87.173
5423,422299.208,4581628.666,87.064
5424,422253.146,4581659.295,88.142
5425,422251.405,4581656.296,88.067
5426,422258.453,4581658.250,88.223
5427,422260.427,4581653.578,88.077
5428,422261.164,4581652.327,88.049
5429,422245.261,4581652.244,87.763
5430,422230.826,4581638.306,87.146
5432,422229.724,4581636.929,87.134
5433,422235.022,4581629.266,87.091
5434,422235.409,4581630.803,87.125
5435,422235.659,4581631.630,87.151
5436,422231.541,4581630.402,87.056
5437,422236.480,4581617.274,86.974
5438,422243.301,4581609.862,86.969
5439,422250.457,4581602.153,86.967
5440,422256.865,4581595.201,86.974
5441,422296.692,4581622.642,87.047
5442,422305.843,4581630.439,87.244
5443,422302.502,4581633.640,87.245
5444,422300.425,4581636.051,87.245
5445,422296.494,4581642.597,87.244
5446,422288.003,4581651.533,87.344
5447,422281.398,4581657.592,87.590
5448,422278.696,4581660.518,87.694
5449,422278.271,4581660.929,87.775
5450,422278.243,4581660.971,87.969
5451,422275.549,4581663.846,88.097
5452,422272.400,4581666.306,88.292
5453,422260.683,4581665.141,88.459
5454,422259.599,4581664.141,88.401
5455,422258.469,4581663.143,88.351

5456,422257.353,4581662.088,88.296
5457,422251.629,4581658.482,88.054
5458,422261.762,4581657.387,88.188
5459,422262.853,4581658.431,88.230
5460,422264.026,4581659.455,88.269
5461,422265.095,4581660.490,88.311
5462,422254.721,4581636.978,87.252
5463,422252.100,4581641.110,87.259
5464,422257.339,4581645.633,87.356
5465,422249.535,4581639.147,87.270
5466,422294.907,4581636.864,87.377
5467,422293.700,4581638.132,87.439
5468,422292.043,4581639.840,87.508
5469,422290.296,4581641.717,87.582
5470,422289.089,4581642.984,87.646
5471,422285.413,4581646.921,87.796
5472,422284.206,4581648.188,87.847
5473,422267.760,4581601.160,86.999
5474,422252.569,4581609.020,87.105
5475,422244.719,4581617.522,87.185
5476,422240.969,4581615.692,87.007
5477,422242.904,4581612.714,86.991
5478,422241.717,4581614.000,86.993
5479,422244.467,4581610.992,86.989
5480,422245.653,4581609.705,86.988
5481,422246.140,4581609.203,86.990
5482,422247.327,4581607.917,86.997
5483,422256.182,4581603.276,87.185
5484,422253.263,4581605.739,87.227
5485,422250.757,4581609.142,87.143
5486,422248.215,4581611.484,87.161
5487,422244.533,4581614.807,87.241
5488,422240.501,4581619.747,87.148
5489,422237.997,4581621.064,87.210
5490,422235.006,4581622.986,87.149
5491,422225.889,4581632.617,87.212
5492,422229.366,4581635.680,87.176
5493,422232.634,4581638.938,87.311
5494,422236.112,4581641.953,87.367
5495,422239.572,4581645.304,87.528
5496,422243.358,4581648.881,87.674
5497,422246.891,4581652.084,87.820
5498,422262.464,4581649.199,87.871
5499,422259.119,4581652.725,88.079
5500,422268.884,4581659.999,88.284
5501,422272.394,4581655.907,88.145
5502,422276.229,4581651.917,87.987
5503,422280.182,4581647.740,87.827
5504,422283.942,4581643.659,87.689
5505,422287.739,4581639.552,87.507
5506,422291.553,4581635.474,87.400
5507,422265.476,4581669.919,88.761
5508,422256.511,4581651.632,88.108
5509,422254.741,4581650.032,87.410
5510,422254.253,4581657.541,88.289
5511,422251.181,4581647.115,87.384
5512,422225.491,4581634.057,86.931
5513,422222.173,4581628.699,86.858
E1,422258.151,4581593.940,86.987
E2,422289.525,4581622.726,87.095
E3,1,422252.704,4581654.058,88.053
E4,422226.010,4581630.303,86.963

ANNEXES

Annex I: Certificat de calibratge Estació Total Leica TS16

INSTOP

- when it has to be right 

Certificado de Verificación y Control

Emitido por Servicio Técnico Autorizado de Leica Geosystems

Certificado N° 037155

Instrumento:	ESTACIÓN TOTAL	Expedido a:	INTERNO INSTOP
Modelo:	TS16P1R500	Fecha revisión:	11-07-2025
N° Serie:	4914831	Próxima revisión:	10-07-2026
		Técnico:	5002

Identificación de patrones

Estación Total Leica, modelo TCA2003, número de serie 442095 con certificado CEM número CEM24004723.

Incertidumbre asociada a los patrones e instrumento objeto

La incertidumbre expandida resultante, asociada a las desviaciones halladas, está expresada para un factor de cobertura $k = 2$, aproximadamente equivalente a un nivel de confianza del 95%. Siguiendo lo establecido en el documento GUM "Guide to the expression of Uncertainty in Measurement", en su versión española 3ª edición de 2009, publicada por el CEM.

Procedimientos de verificación

Patrones:	Procedimiento descrito en documentación interna de Leica Geosystems PCP LG 09-20 basado en el documento DI-039 para la calibración de colimadores ópticos desarrollado por el CEM.
Instrumento:	Procedimiento descrito en documentación interna de Leica Geosystems S.L., P.V. IT LG 09-20, P.A. IT LG 09-20.

Condiciones ambientales

Temperatura durante la revisión 20°C +/-5°C.
Los resultados se refieren al momento y condiciones en que se efectuaron las mediciones.

Certificado

Por la presente, certificamos que el producto descrito ha sido testado de acuerdo con los procedimientos del Servicio Técnico de Instop S.L.U., obteniendo los siguientes resultados:

☒ Conforme Los resultados del ensayo cumplen con las especificaciones del producto.
☐ No Conforme Los resultados del ensayo no cumplen con las especificaciones del producto.

El equipo utilizado para la prueba tiene trazabilidad con los estándares nacionales.

Este Certificado no puede ser reproducido parcial ni en su totalidad sin previa aprobación escrita de la entidad emisora

Página 1/2

Lecturas

Nº de Certificado

037155

Entrada:

	1	2	3	4	5
Error Angular (gon)					
Colimación Horizontal	---	---	---	---	---
Índice Vertical	---	---	---	---	---
Error Distancia (mm)					
Normal (prisma)	---	---	---	---	---
Normal (cualquier superficie)	---	---	---	---	---

Salida:

	1	2	3	4	5
Error Angular (gon)					
Colimación Horizontal	0.0003	0.0002	0.0002	0.0003	0.0002
Índice Vertical	0.0002	0.0002	0.0003	0.0003	0.0002
Error Distancia (mm)					
Normal (prisma)	0.6	0.5	0.6	0.5	0.6
Normal (cualquier superficie)	0.7	0.6	0.7	0.6	0.6

Precisión Calculada

	Entrada	Tolerancia	Salida	Incertidumbre
Precisión Angular (gon)				
Horizontal	---	0.0003	0.0001	0.0011
Vertical	---	0.0003	0.0001	0.0010
Precisión Distancia (mm)				
Normal (prisma)	---	1mm + 1.5ppm	0.1	0.57
Normal (cualquier superficie)	---	2mm + 2ppm	0.1	0.57

Valores

Los valores reflejados en la Precisión Calculada (entrada y salida) son el resultado del cálculo de la Desviación Estándar del promedio de las Lecturas.

Instop, SLU



Josep Colén Ortego - Ingeniero Técnico Industrial

Este Certificado no puede ser reproducido parcial ni en su totalidad sin previa aprobación escrita de la entidad emisora

Annex II: Certificat de calibratge Làser escàner Leica RTC 360



Leica Geosystems Calibration Certificate Blue

Calibration Certificate Blue without measurement values issued by Manufacturer

Product	RTC 360 Laser Scanner	Certificate No.	2989506-17042025
Article No.	838300	Inspection Date	17.04.2025
Serial No.	2989506	Order No.	4002034
Equipment No.	31503775	PO No.	Proforma RTC360 -4
Issued by	Manufacturer Leica Geosystems AG Köln Alemania	Ordered by	INSTOP CATALUNYA, S.L. La Pobla de Claramunt Espanya
		Customer	INSTOP CATALUNYA, S.L. La Pobla de Claramunt Espanya

Compliance

The Calibration Certificate Blue without measurement values issued by Manufacturer corresponds to a declaration of conformity in line with the requirements of ISO/IEC 17050-1.

Certificate

We hereby certify that the product described has been tested and complies with the specifications of the product. The test equipment used is traceable to national standards or to recognized procedures. This is established by our Quality Management System, audited and certified to ISO 9001.

Leica Geosystems AG

17.04.2025



Dennis Weidenbruecher
Manager

Murat Deniz
Team Leader

Certificate No. 2989506-17042025
Article No. 5003367
This Certificate may not be reproduced other than in full except with prior written approval of the issuing authority.

Leica Geosystems AG
Heinrich-Wild-Strasse
9435 Heiterthugg
Switzerland
Telephone +41 71 / 727 31 31
www.leica-geosystems.com

Annex III: Certificat de calibratge Receptor GNSS Leica GS18

INSTOP

- when it has to be right

Leica
Geosystems

Leica Geosystems Certificado de Calibración Blue

Certificado de Calibración "Blue" sin valores de medición, emitido por un Centro de Servicio Técnico autorizado.

Producto	GPS GS18T	Nº de Certificado	033071
Nº Serie	4901185	Fecha Inspección	21 de September de 2023
Emitido por	Authorised Service Center Instop, SLU La Pobla de Claramunt (BCN) Spain	Nº de pedido	
		Solicitado por	SIBINA TOPOGRAFIA, SLU
		Ciente	SIBINA TOPOGRAFIA, SLU

Conformidad

El Certificado de Calibración "Blue" sin valores de medición, emitido por un Centro de Servicio Técnico autorizado, corresponde con el Certificado o de Inspección del Fabricante, de acuerdo con la DIN 55 350 Parte 18-4.2.1.

Certificado

Por la presente, certificamos que el producto descrito ha sido testeado y cumple con las especificaciones del producto. El equipo utilizado para el test tiene trazabilidad con los estándares nacionales o con procedimiento reconocidos por una entidad acreditadora nacional.

Instop, SLU
21 de September de 2023



Josep Colén Ortego - Ingeniero Técnico Industrial

Leica
Geosystems

Nº de certificado 033071
Nº Artículo GS18T
Este Certificado no puede ser reproducido parcial ni en su totalidad, sin previa aprobación escrita de la entidad emisora.

Instop,SLU
c/Narcís Monturiol, 14, nave 3
08787 - La Pobla de Claramunt
Barcelona (Spain)
+34 938 039 576
www.instop.es

Annex IV Ressenyes Bases de Replanteig i Bases de Referència XTM

RESSENYA BASE REPLANTEIG

PROJECTE:

AIXECAMENT TOPOGRÀFIC ÀMBIT CENTRE D'ATENCIÓ PRIMÀRIA DE SANT JUST DESVERN

TERME MUNICIPAL:

SANT JUST DESVERN

PROVINCIA:

BARCELONA

NOM BASE:

5001

Sistema de referència:

ETRS 89

Projecció:

UTM FUS 31 N

Model de geoide:

EGM08D595

Data:

#####

Metodologia:

GNSS

Senyal:

Clau d'acer

UTM X

422.300,963

UTM Y

4.581.627,946

Cota ortomètrica H

87,098

Anamorfosi

0,99967477

Situació:

Clau d'acer sobre vorera a la cantonada del C/Jacint Benavente

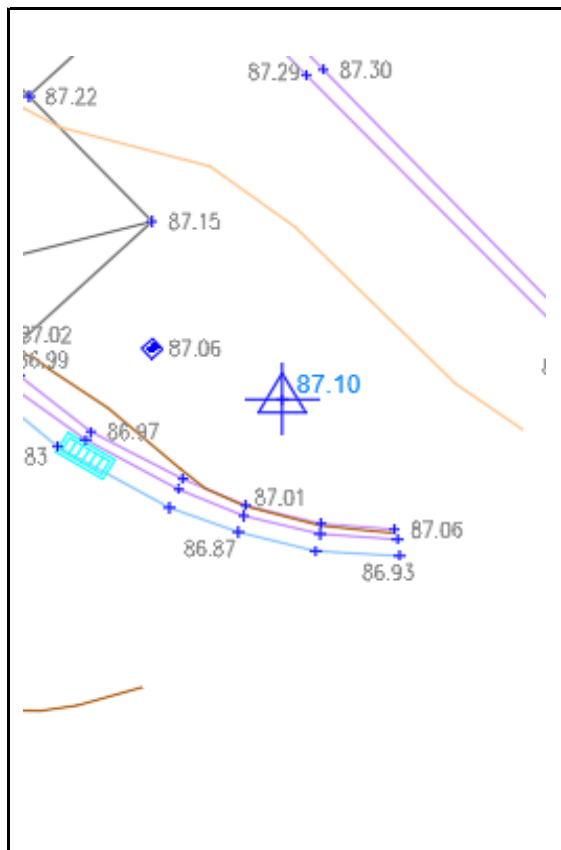

RESSENYA BASE REPLANTEIG

PROJECTE:

AIXECAMENT TOPOGRÀFIC ÀMBIT CENTRE D'ATENCIÓ PRIMÀRIA DE SANT JUST DESVERN

TERME MUNICIPAL:

SANT JUST DESVERN

PROVINCIA:

BARCELONA

NOM BASE:

5002

Sistema de referència:

ETRS 89

Projecció:

UTM FUS 31 N

Model de geoide:

EGM08D595

Data:

#####

Metodologia:

GNSS

Senyal:

Clau d'acer

UTM X

422.267,986

UTM Y

4.581.629,024

Cota ortomètrica H

87,232

Anamorfosi

0,99967477

Situació:

Clau d'acer sobre vorera a la junta de paviment de formigó. Entre dos embornals

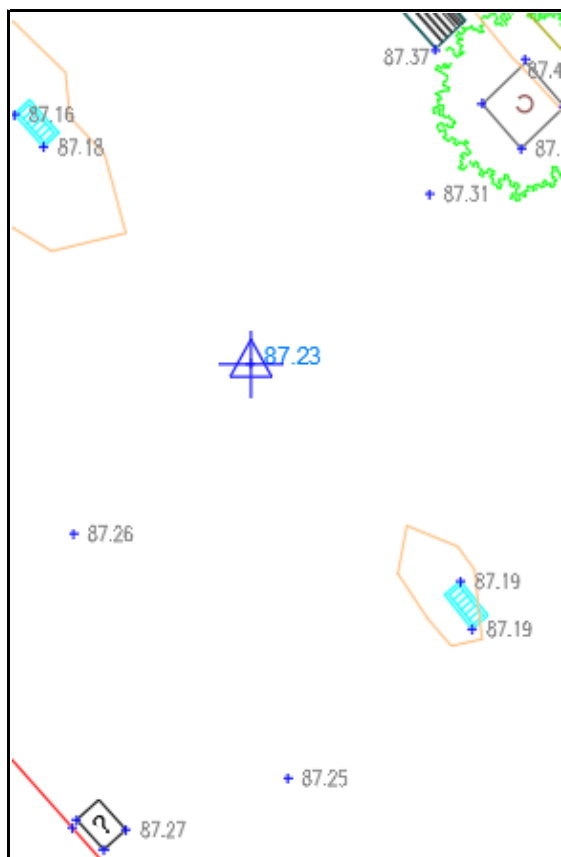

RESSENYA BASE REPLANTEIG

PROJECTE:

AIXECAMENT TOPOGRÀFIC ÀMBIT CENTRE D'ATENCIÓ PRIMÀRIA DE SANT JUST DESVERN

TERME MUNICIPAL:

SANT JUST DESVERN

PROVINCIA:

BARCELONA

NOM BASE:

5003

Sistema de referència:

ETRS 89

Projecció:

UTM FUS 31 N

Model de geoide:

EGM08D595

Data:

#####

Metodologia:

GNSS

Senyal:

Clau d'acer

UTM X

422.282,371

UTM Y

4.581.663,103

Cota ortomètrica H

87,663

Anamorfosi

0,99967477

Situació:

Clau d'acer a la junta de paviment de la rampa de formigó d'accés al Casal de Joves

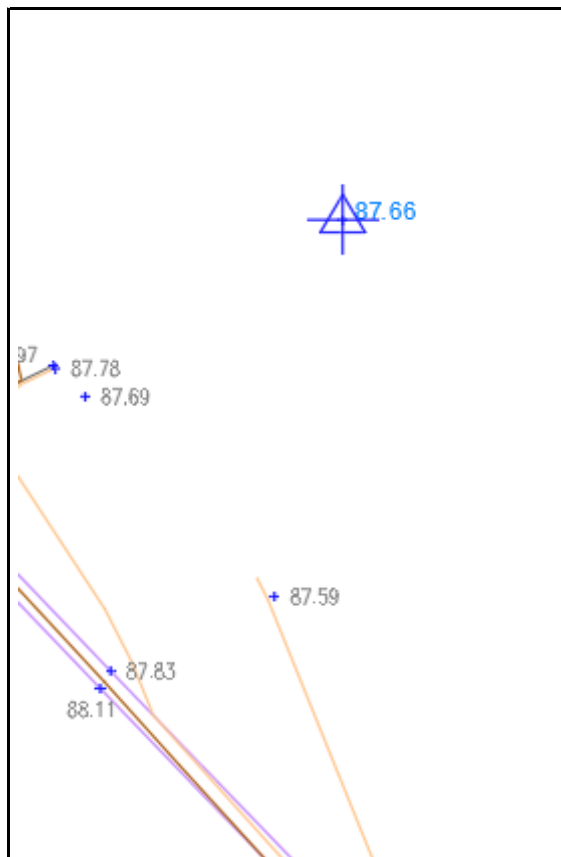

Annex V: Plànols

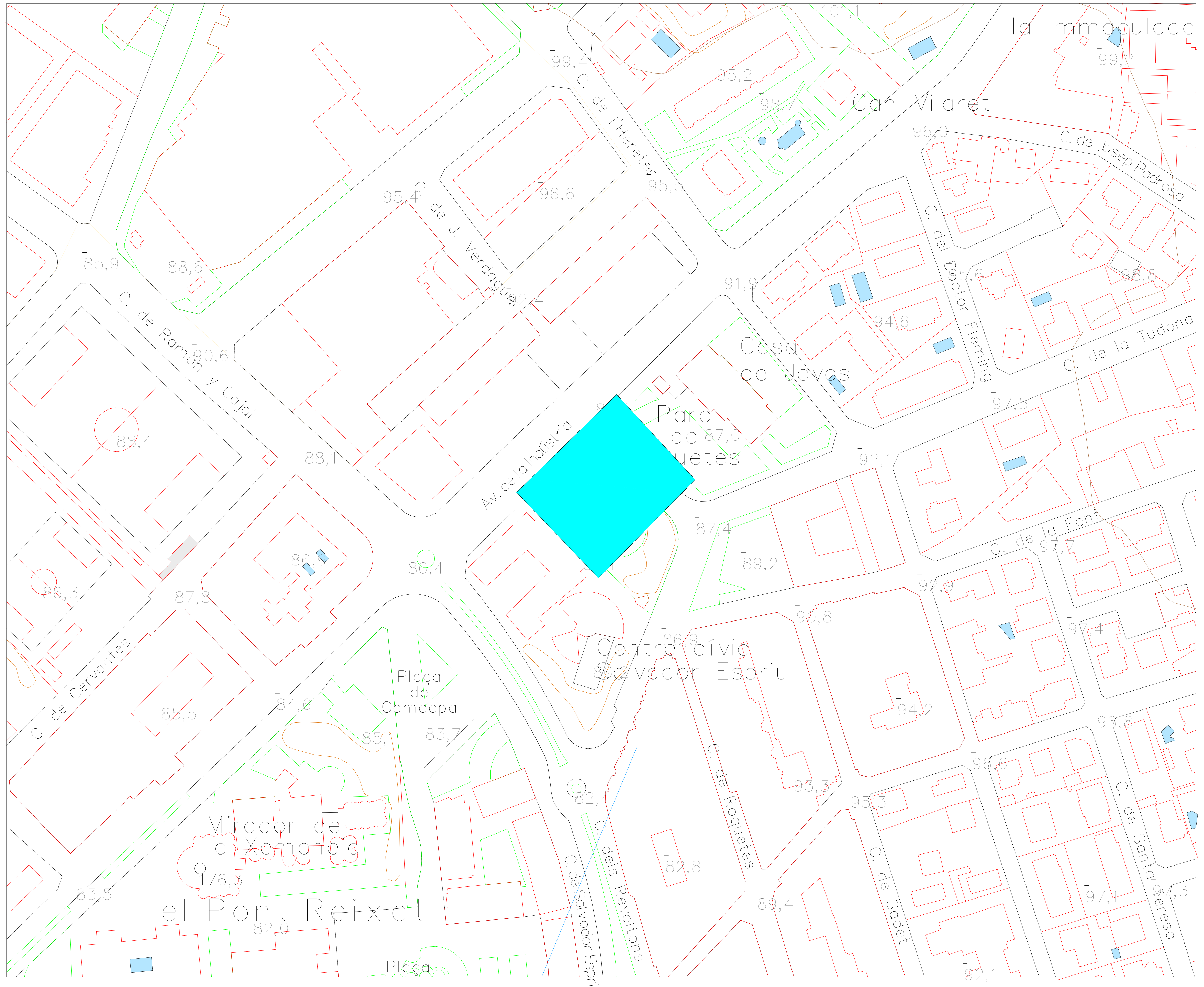

X= 422180
Y= 4581690

X= 422340
Y= 4581690

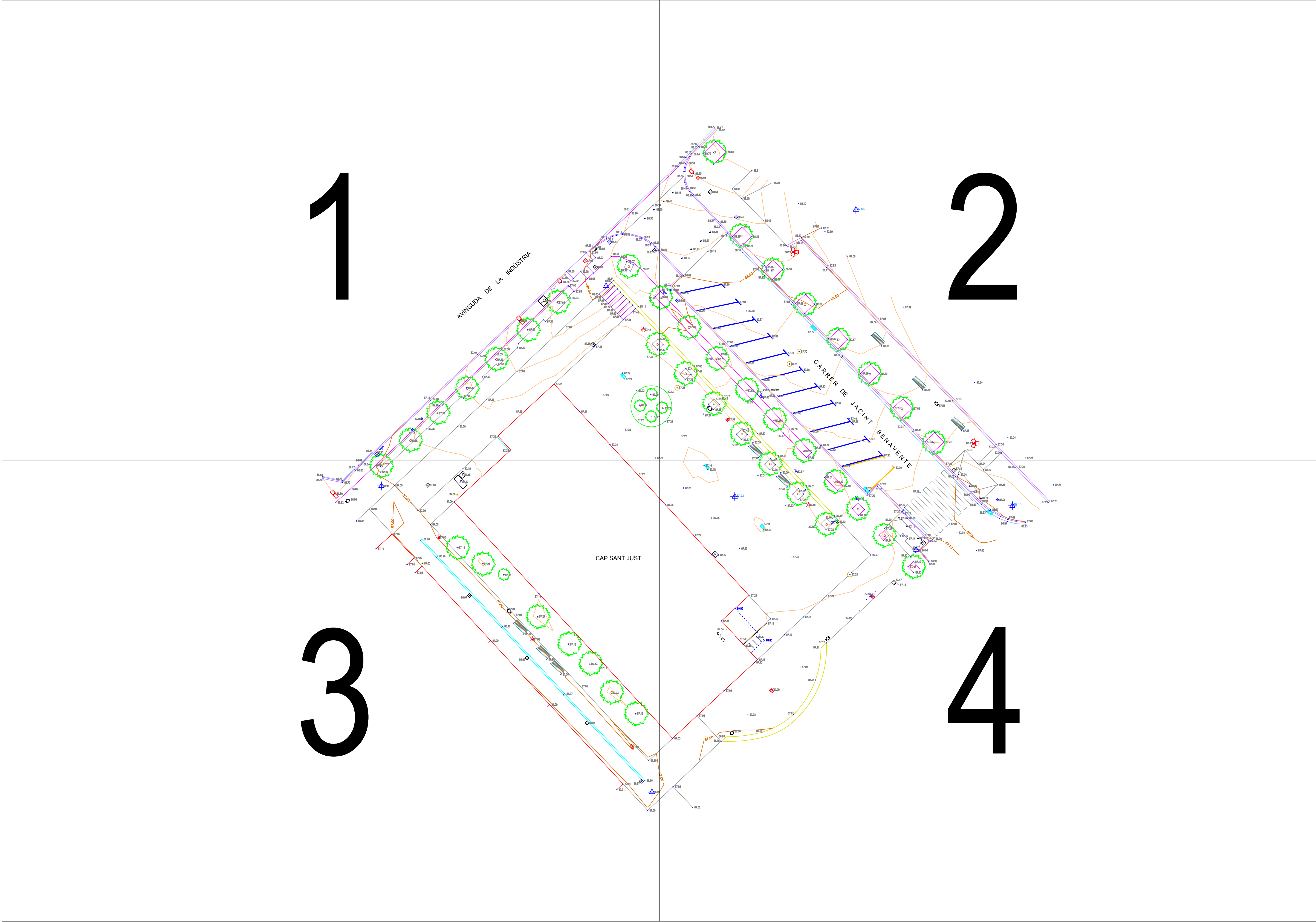

X= 422180
Y= 4581570

X= 422340
Y= 4581570

X= 422180
Y= 4581690

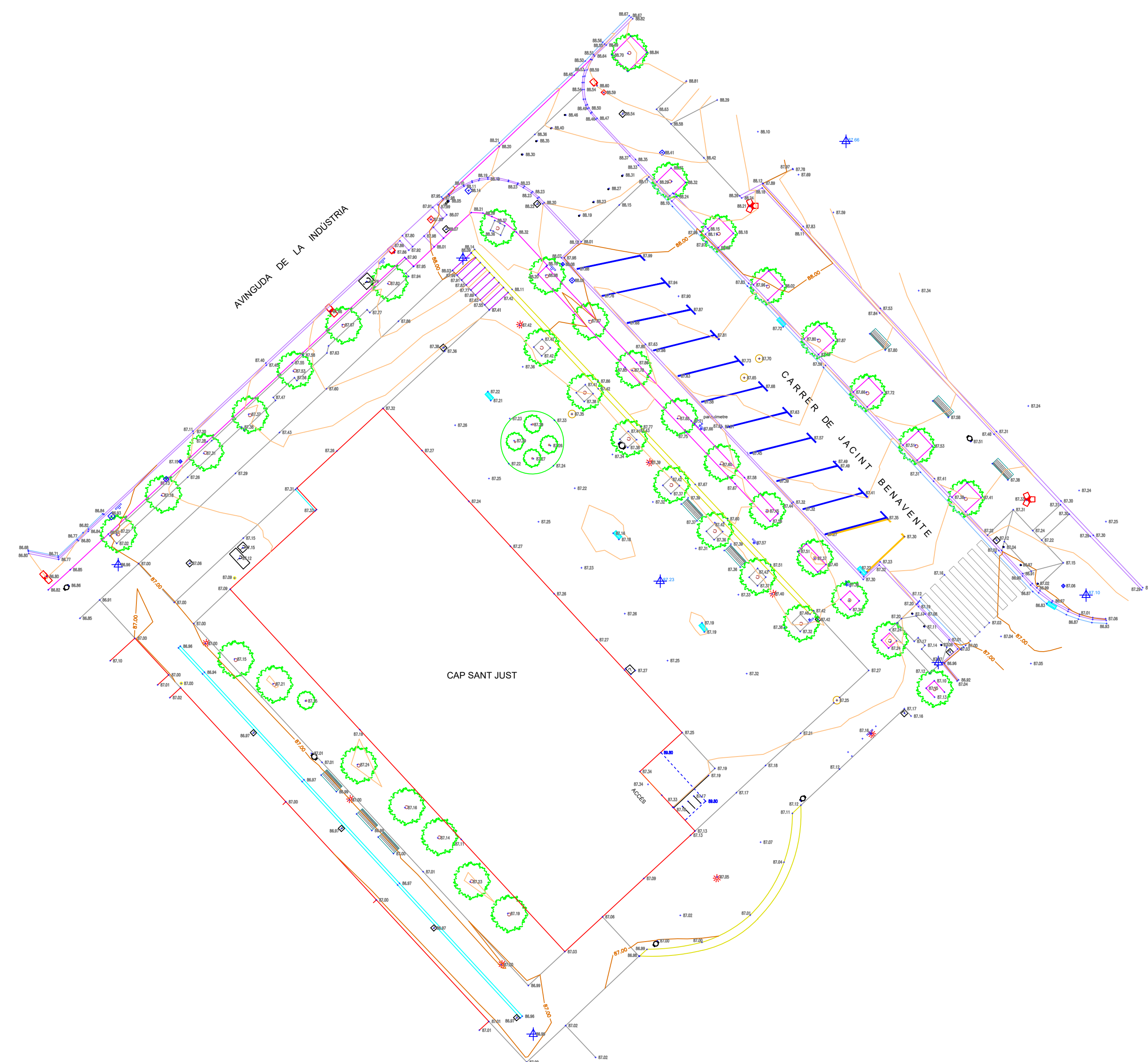
$$\begin{array}{r} X = 422340 \\ + Y = 4581690 \\ \hline \end{array}$$

X= 422180
Y= 4581570

$$\begin{array}{r} X = 422340 \\ + Y = 4581570 \\ \hline \end{array}$$

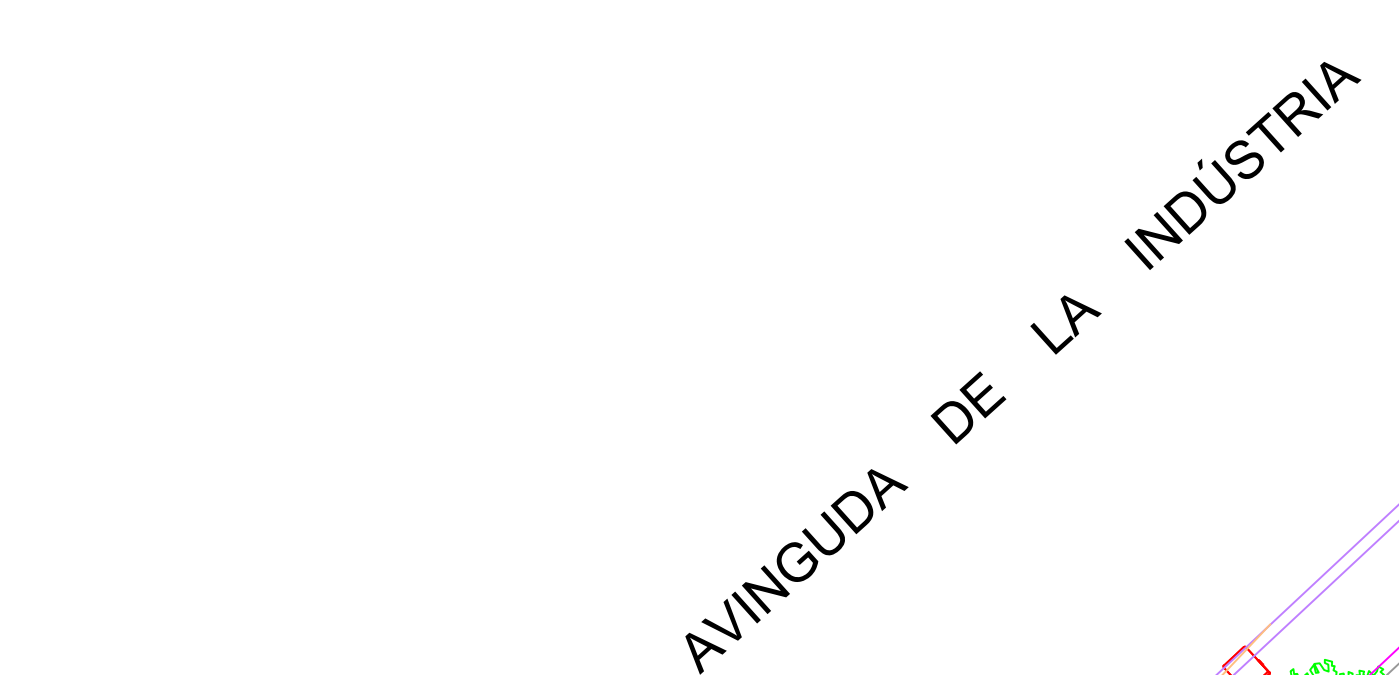
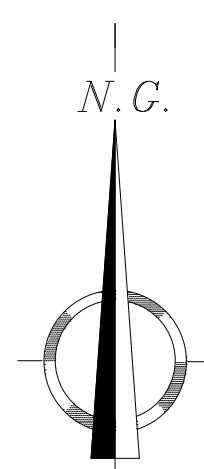

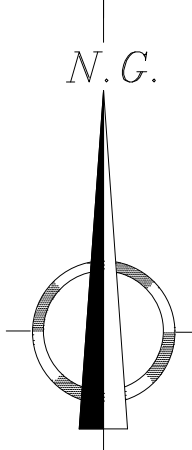
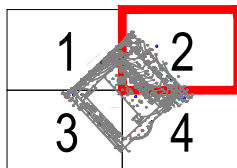
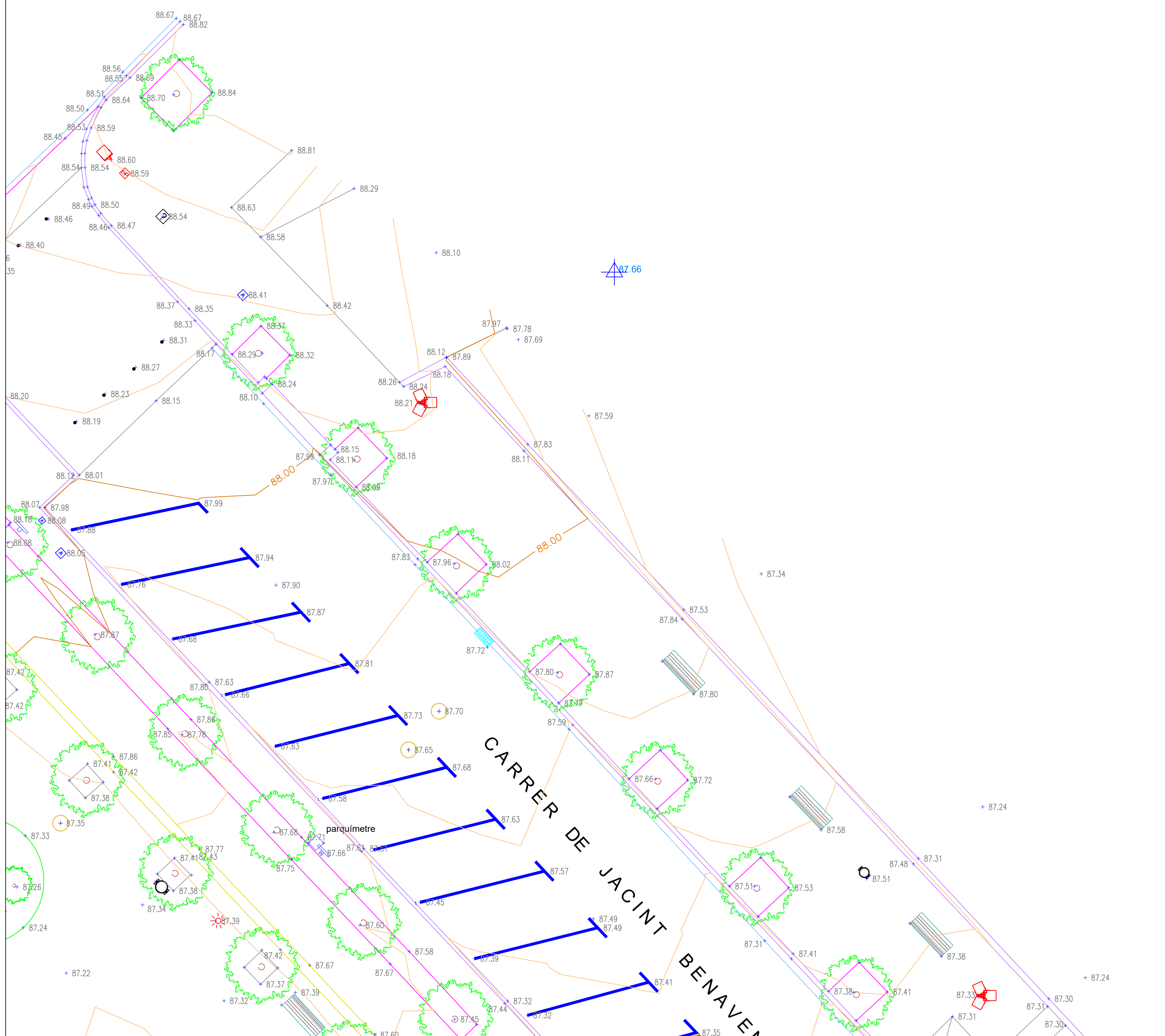

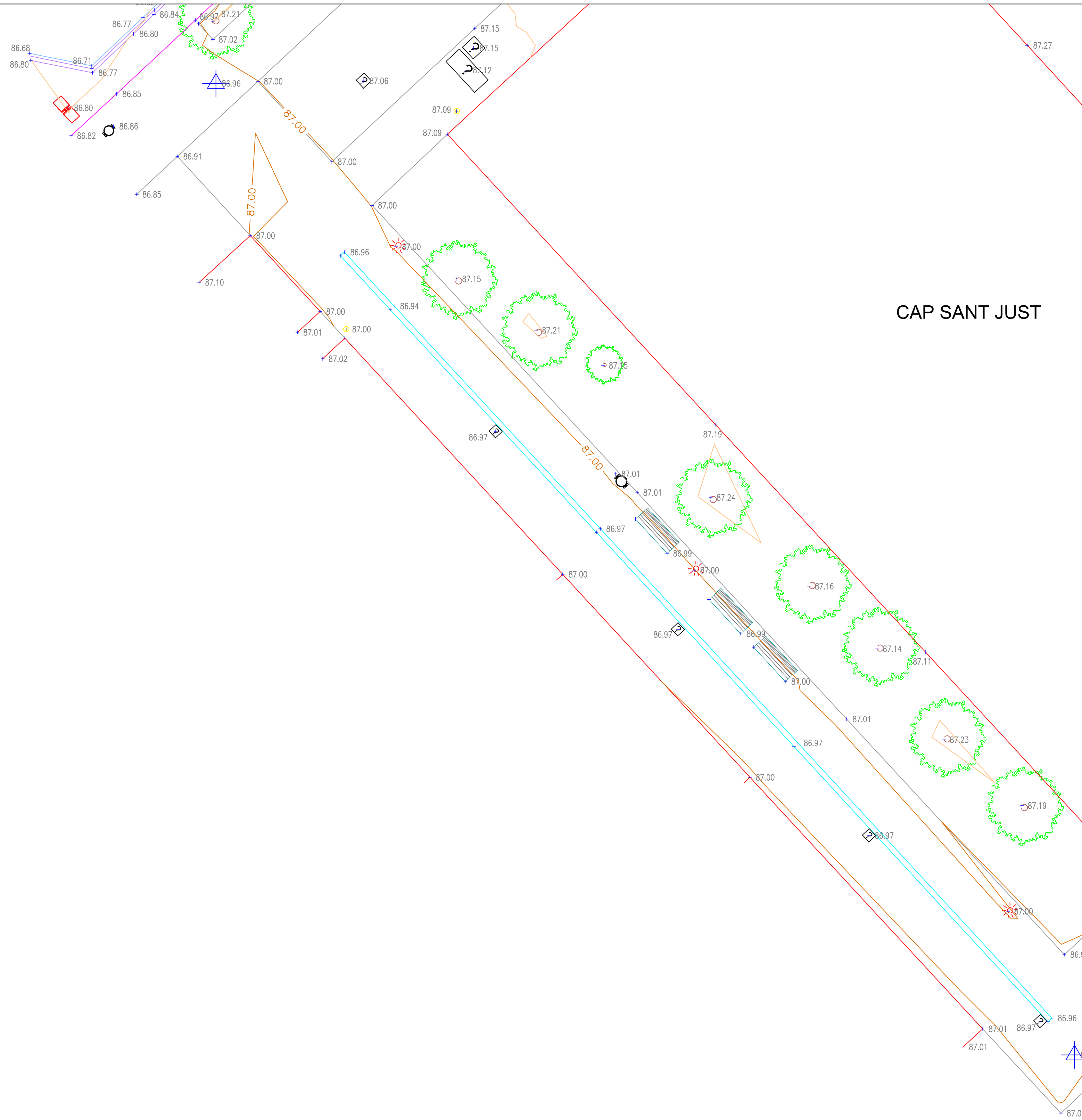
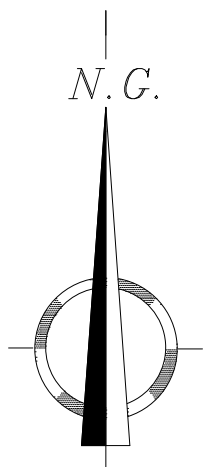
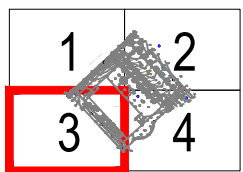

CAP SANT JUST

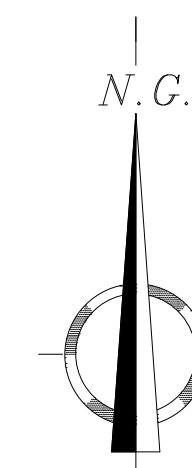
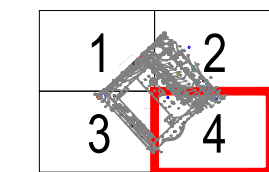

X= 422180
Y= 4581690

X= 422340
Y= 4581690

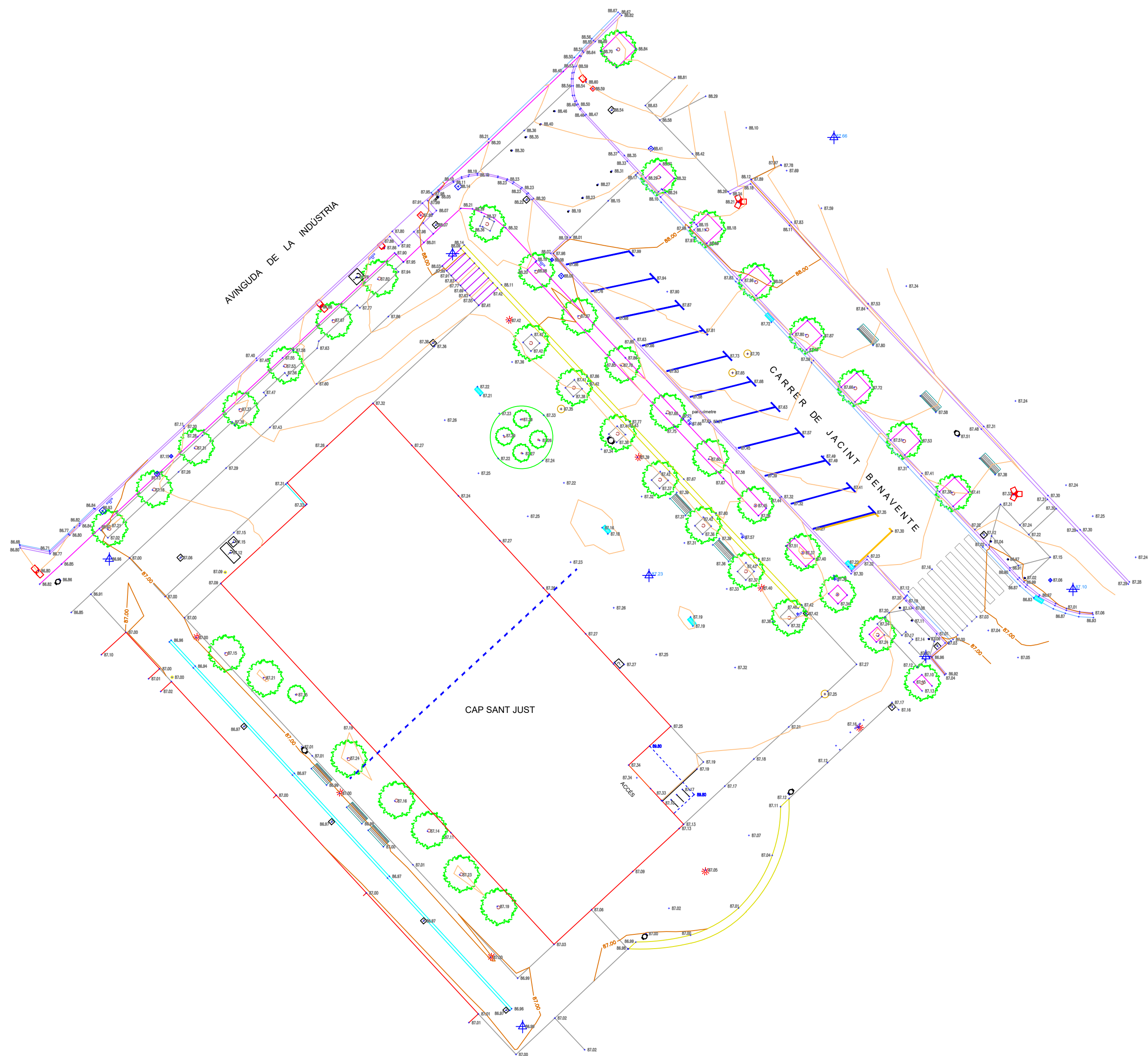
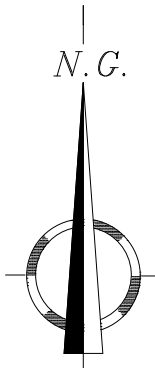

X= 422180
Y= 4581570

X= 422340
Y= 4581570

